

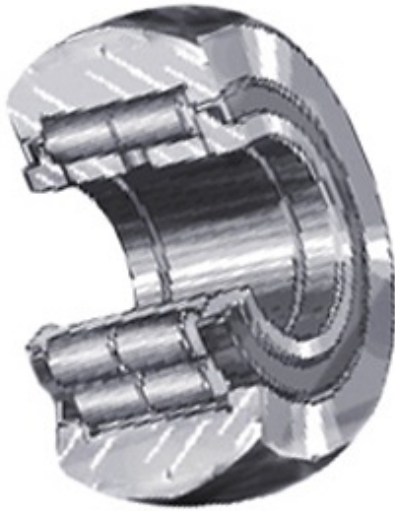

# BEARING CORP.OF CANADA LTD.

## INA PWTR3072-2RS Cam Follower and Track Roller - Yoke Type



Bearing No. PWTR3072-2RS

PWTR3072-2RS Bearing 2D drawings and 3D CAD models

|                        |   |
|------------------------|---|
| Category               | Cam Follower and Track Roller - Yoke Type   |
| Inventory              | 0.0   |
| Manufacturer Name      | SCHAEFFLER GROUP  |
| Minimum Buy Quantity   | N/A   |
| Weight                 | 0.835   |
| EAN                    | 4012802625615   |
| Product Group          | B04120  |
| Roller Surface Profile | Crowned   |
| Profile                | Yoke Type   |
| Enclosure              | Sealed  |
| Rolling Element        | Cylindrical Roller Bearing-Double Row   |
| Relubricatable         | Yes   |
| Inch - Metric          | Metric  |
| Other Features         | Full Complement   Heavy Duty   With Inner Ring   Contact Lip Seals  |
| Long Description       | 30MM Bore; 72MM Roller Diameter; 28MM Roller Width; Crowned Roller Surface Profile; Sealed Enclosure; Cylindrical Roller Bearing-Double Row; Relubricatable |
| Category               | Cam Followers Yoke Type   |
| UNSPSC                 | 31171530  |
| Harmonized Tariff Code | 8482.50.00.00   |
|                        |   |



## BEARING CORP.OF CANADA LTD.

| Noun                     | Bearing   |
|--------------------------|---|
| Keyword String           | Cam Follower  |
| Manufacturer URL         | <a href="http://www.ina.com">http://www.ina.com</a> |
| Manufacturer Item Number | PWTR30722RS   |
| Weight / LBS             | 1.537   |
| Roller Diameter          | 2.835 Inch   72 Millimeter                          |
| Roller Width             | 1.102 Inch   28 Millimeter                          |
| d                        | 1.181 Inch   30 Millimeter                          |